

Position switch in compact design 40 mm wide with connector plug  
M12 Snap-action contacts 1 NO+1 NC with twist lever



product brand name	SIRIUS
product designation	Mechanical position switches
product type designation	3SE5
suitability for use safety switch	Yes

General technical data	
product function	
<ul style="list-style-type: none"> <li>positive opening</li> </ul>	Yes
insulation voltage	
<ul style="list-style-type: none"> <li>rated value</li> </ul>	400 V
degree of pollution	3
surge voltage resistance rated value	4 kV
protection class IP	IP67
shock resistance	
<ul style="list-style-type: none"> <li>acc. to IEC 60068-2-27</li> </ul>	30g / 11 ms
vibration resistance	
<ul style="list-style-type: none"> <li>acc. to IEC 60068-2-6</li> </ul>	0.35 mm/5g
mechanical service life (switching cycles)	
<ul style="list-style-type: none"> <li>typical</li> </ul>	5 000 000
electrical endurance (switching cycles)	

<ul style="list-style-type: none"> <li>• at AC-15 at 230 V typical</li> </ul>	100 000
<b>electrical endurance (switching cycles) with contactor 3RH11, 3RT1016, 3RT1017, 3RT1024, 3RT1025, 3RT1026 typical</b>	500 000
<b>Electrical operating cycles in one hour with contactor 3RH11, 3RT1016, 3RT1017, 3RT1024, 3RT1025, 3RT1026</b>	1 800
<b>thermal current</b>	10 A
<b>material of the enclosure of the switch head</b>	metal
<b>reference code acc. to DIN EN 81346-2</b>	B
<b>active principle</b>	mechanical
<b>repeat accuracy</b>	0.05 mm
<b>minimum actuating torque in activation direction</b>	0.2 N·m
<b>length of the sensor</b>	95 mm
<b>width of the sensor</b>	40 mm
<b>design of the switching contact</b>	mechanical
<b>operating frequency rated value</b>	50 ... 60 Hz
<b>number of NC contacts for auxiliary contacts</b>	1
<b>number of NO contacts for auxiliary contacts</b>	1
<ul style="list-style-type: none"> <li>• operating current at AC-15 at 125 V rated value</li> <li>• operational current at AC-15 at 230 V rated value</li> </ul>	6 A 3 A
<b>operating current at DC-13</b>	
<ul style="list-style-type: none"> <li>• at 125 V rated value</li> <li>• at 230 V rated value</li> </ul>	0.55 A 0.27 A
<b>design of the interface for safety-related communication</b>	without

### Enclosure

<b>design of the housing</b>	block
<b>material of the enclosure</b>	metal
<b>coating of the enclosure</b>	painted
<b>design of the housing acc. to standard</b>	No

### Drive Head

<b>design of the operating mechanism</b>	twist lever
<b>shape of the switch head</b>	lever
<b>design of the switching function</b>	snap-action contact
<b>circuit principle</b>	snap-action contacts
<b>number of switching contacts safety-related</b>	1

### Connections/ Terminals

<b>type of electrical connection</b>	M12 plug, fixed, 5-pole
<b>design of plug-in connection</b>	M12 connector, 5-pole: pin 1= terminal BK, pin 2= BK/WH, pin 3= BU, pin 4= BN, pin 5= GN/YE

## Communication/ Protocol

design of the interface without

## Ambient conditions

explosion protection category for dust none

## Installation/ mounting/ dimensions

mounting position any

- mounting type screw fixing

## Certificates/ approvals

### General Product Approval

### Declaration of Conformity

### other



CCC



UR



EG-Konf.

[Miscellaneous](#)

[Confirmation](#)

## Further information

### Information- and Downloadcenter (Catalogs, Brochures,...)

<https://www.siemens.com/ic10>

### Industry Mall (Online ordering system)

<https://mall.industry.siemens.com/mall/en/en/Catalog/product?mlfb=3SE5423-0CN20-1EB1>

### Cax online generator

<http://support.automation.siemens.com/WW/CAXorder/default.aspx?lang=en&mlfb=3SE5423-0CN20-1EB1>

### Service&Support (Manuals, Certificates, Characteristics, FAQs,...)

<https://support.industry.siemens.com/cs/ww/en/ps/3SE5423-0CN20-1EB1>

### Image database (product images, 2D dimension drawings, 3D models, device circuit diagrams, EPLAN macros, ...)

[http://www.automation.siemens.com/bilddb/cax\\_de.aspx?mlfb=3SE5423-0CN20-1EB1&lang=en](http://www.automation.siemens.com/bilddb/cax_de.aspx?mlfb=3SE5423-0CN20-1EB1&lang=en)

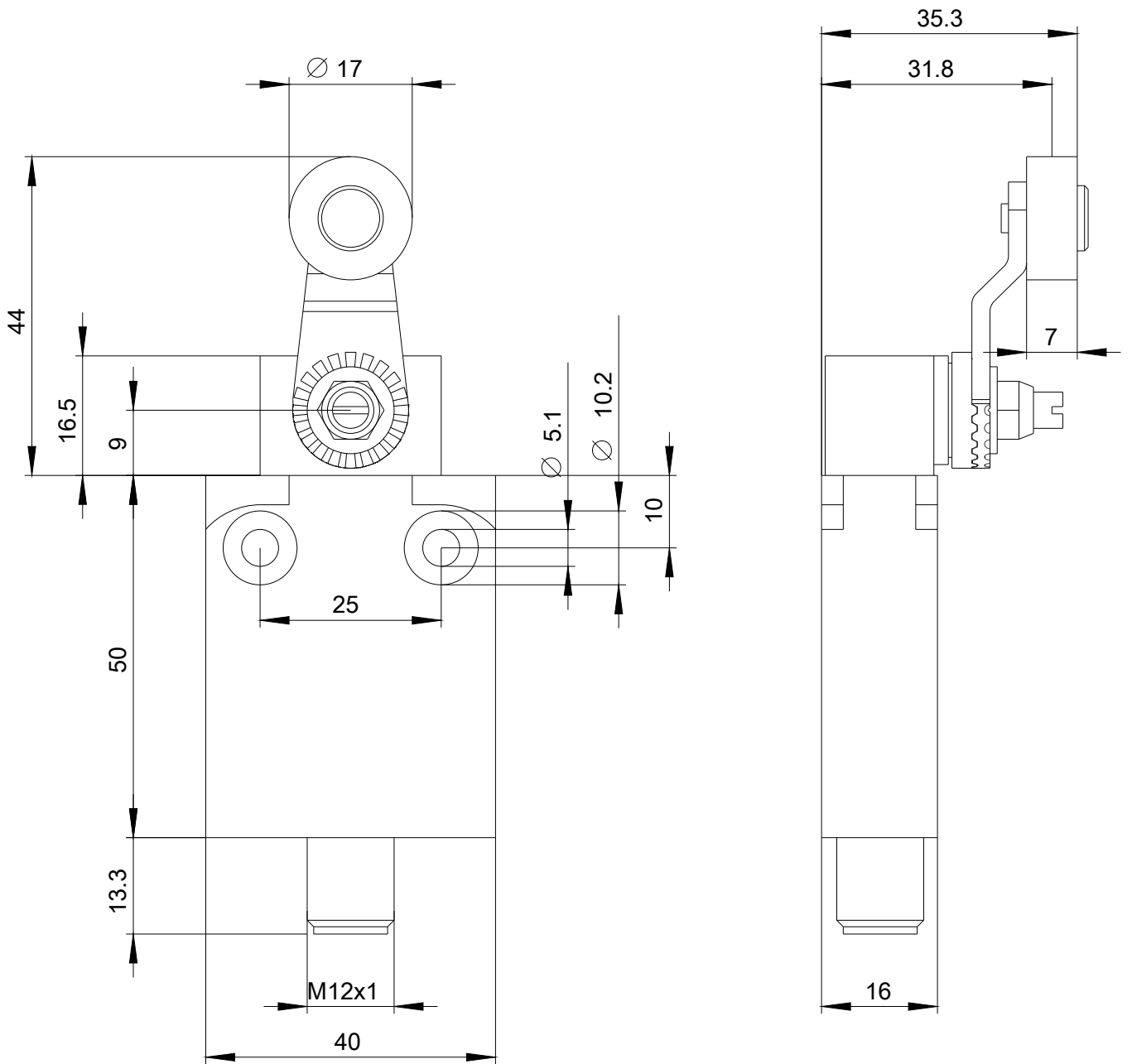

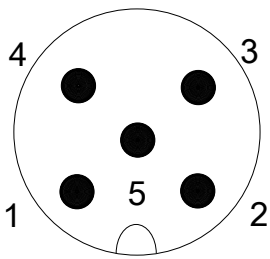

1	BK = Black	→	22
2	BK/WH = Black/White	→	21
3	BU = Blue	→	14
4	BN = Brown	→	13
5	GY/YE = Grey/Yellow	→	PE

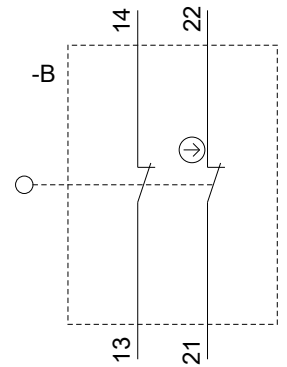

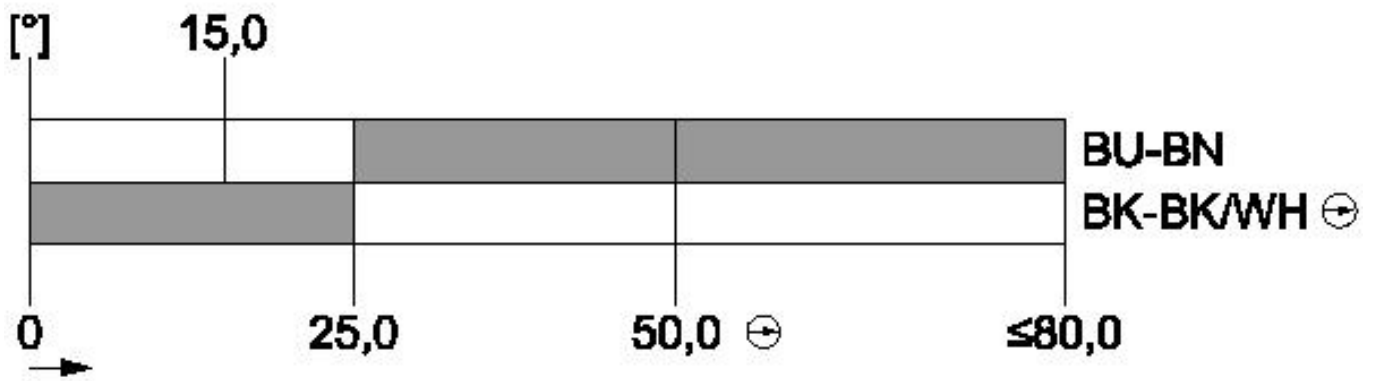

last modified:

09/29/2020