

Current transformer 0.3...3 A for 3RB22/23/24 Size S00/S0 Stand-alone installation Main circuit: straight-through transformer Auxiliary circuit: --



Product brand name	SIRIUS
Product designation	Current measuring module
General technical data	
Type of protection according to ATEX directive 2014/34/EU	Ex II (2) GD
Certificate of suitability according to ATEX directive 2014/34/EU	PTB 05 ATEX 3022
Main circuit	
Adjustable pick-up value current of the current-dependent overload release	0.3 ... 3 A
Installation/ mounting/ dimensions	
Mounting type	stand-alone installation
Connections/ Terminals	
Type of electrical connection	straight-through transformers
<ul style="list-style-type: none"> • for main current circuit 	
Certificates/ approvals	

General Product Approval	For use in hazardous locations	Declaration of Conformity
--------------------------	--------------------------------	---------------------------



Declaration of Conformity	Test Certificates	Marine / Shipping
---------------------------	-------------------	-------------------

[Miscellaneous](#)

[Special Test Certificate](#)

[Type Test Certificates/Test Report](#)



Marine / Shipping	other
-------------------	-------



[Confirmation](#)

Further information

Information- and Downloadcenter (Catalogs, Brochures,...)

<https://www.siemens.com/ic10>

Industry Mall (Online ordering system)

<https://mall.industry.siemens.com/mall/en/en/Catalog/product?mlfb=3RB2906-2BG1>

Cax online generator

<http://support.automation.siemens.com/WW/CAXorder/default.aspx?lang=en&mlfb=3RB2906-2BG1>

Service&Support (Manuals, Certificates, Characteristics, FAQs,...)

<https://support.industry.siemens.com/cs/ww/en/ps/3RB2906-2BG1>

Image database (product images, 2D dimension drawings, 3D models, device circuit diagrams, EPLAN macros, ...)

http://www.automation.siemens.com/bilddb/cax_de.aspx?mlfb=3RB2906-2BG1&lang=en

Characteristic: Tripping characteristics, I^t, Let-through current

<https://support.industry.siemens.com/cs/ww/en/ps/3RB2906-2BG1/char>

Further characteristics (e.g. electrical endurance, switching frequency)

<http://www.automation.siemens.com/bilddb/index.aspx?view=Search&mlfb=3RB2906-2BG1&objecttype=14&gridview=view1>

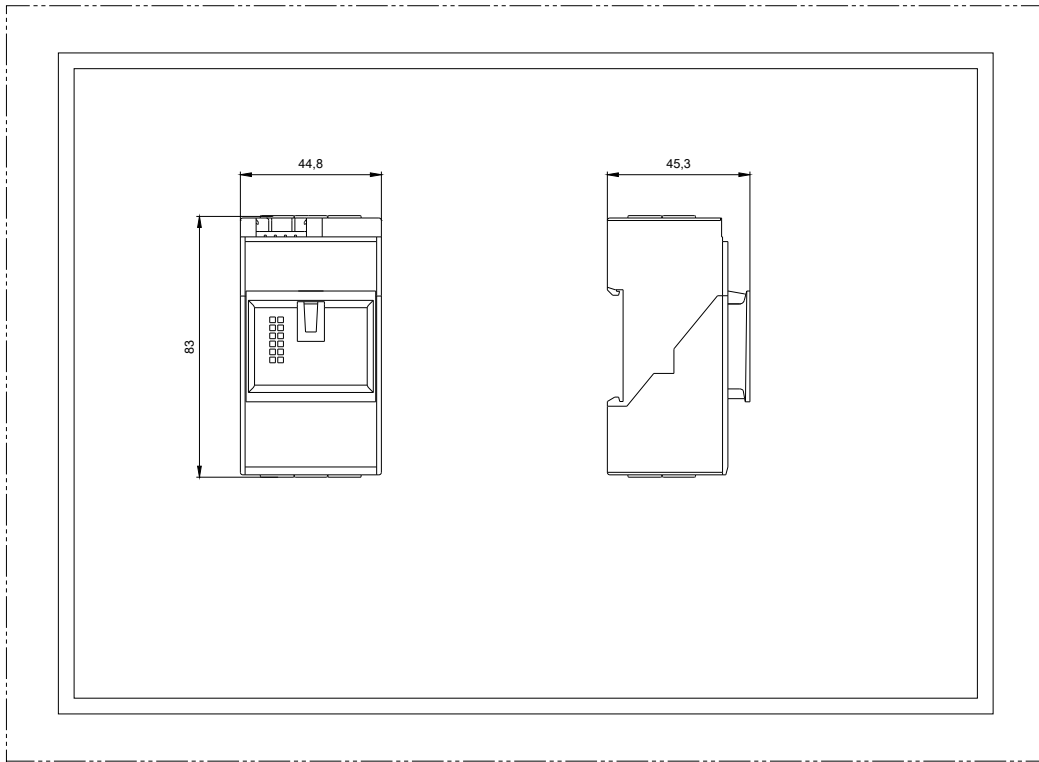

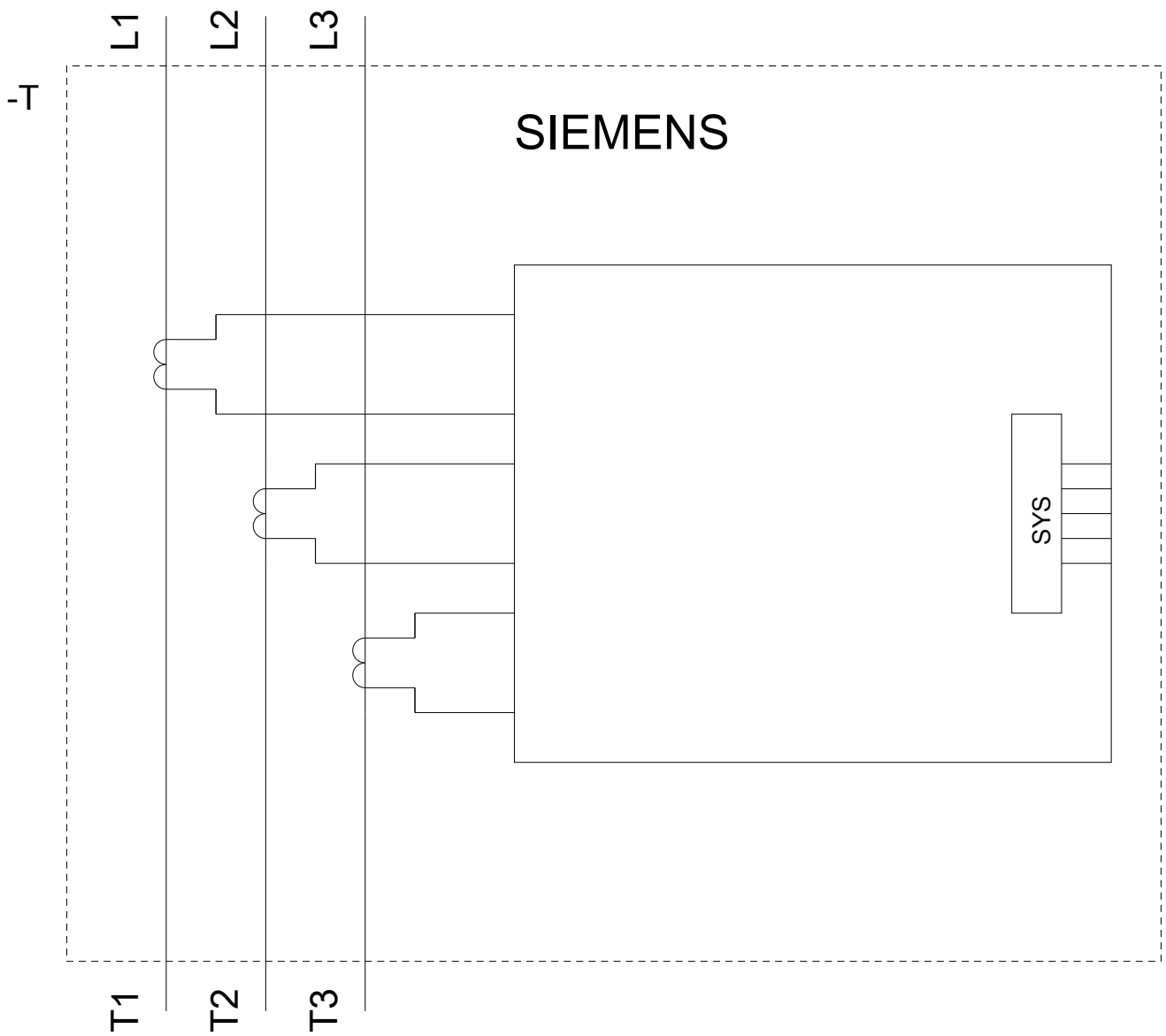

last modified:

05/13/2020