

# Cylindrical design

## Series 06



Short is beautiful. And, it offers mounting advantages over similar, but longer-bodied sensing products. Baumer electric's 6 mm inductive proximity switches offer a housing length of just 28 mm, the shortest in the world. And, they offer an M8 x 1 quick disconnect to boot. Why bother buying any other sensor?



### Dimensions

#### Special characteristics

#### Nominal sensing distance $S_n$

**Mounting** ● shielded

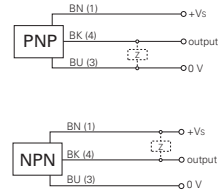

#### PNP

normally open	NO
normally closed	NC

#### NPN

normally open	NO
normally closed	NC

#### technical data

voltage supply range
supply current
max. switching current
voltage drop
max. switching frequency
sensing distance $S_n$
switching hysteresis (as % of $S_n$ )

output indicator
short circuit protection
reverse polarity protection

temperature range
housing material
sensing face material
protection class

connector options

remarks

mounting variation  $\varnothing 6,5$  with clamping nut 117742

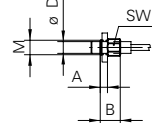

see accessories page 14

6,5 mm		6,5 mm		6,5 mm	
shortest connector version worldwide high switching frequency		robust steel housing high switching frequency		robust steel housing high switching frequency	
2 mm	2 mm	2 mm	2 mm	2 mm	2 mm
IFRM 06P1713/L	IFRM 06P17A5/S35L	IFRM 06P1701/L	IFRM 06P17A3/S35L	IFRM 06P17A1/L	IFRM 06P17A1/S35L
IFRM 06P3713/L	IFRM 06P37A5/S35L	IFRM 06P3701/L	IFRM 06P37A3/S35L	IFRM 06P37A1/L	IFRM 06P37A1/S35L
IFRM 06N1713/L	IFRM 06N17A5/S35L	IFRM 06N1701/L	IFRM 06N17A3/S35L	IFRM 06N17A1/L	IFRM 06N17A1/S35L
IFRM 06N3713/L	IFRM 06N37A5/S35L	IFRM 06N3701/L	IFRM 06N37A3/S35L	IFRM 06N37A1/L	IFRM 06N37A1/S35L
10 - 30 VDC < 12 mA 200 mA < 2 V 5 kHz 2 mm 3...20 %		10 - 30 VDC < 12 mA 200 mA < 2 V 5 kHz 2 mm 3...20 %		10 - 30 VDC < 12 mA 200 mA < 2 V 5 kHz 2 mm 3...20 %	
red LED	3 port LED red	red LED	3 port LED red	red LED	3 port LED red
yes		yes		yes	
yes		yes		yes	
-25...+75 °C stainless steel (1.4305) PBT IP 67		-25...+75 °C stainless steel (1.4305) PBT IP 67		-25...+75 °C stainless steel (1.4305) PBT IP 67	
ESW 31, ESG 32		ESW 31, ESG 32		ESW 31, ESG 32	
support 109474 for details see accessories section		support 109474 for details see accessories section		support 109474 for details see accessories section	