

SIGNALLING COLUMN SIREN ELEMENT ALTERNATING SOUND,  
24V DC,105DB, IP40



Figure similar

General technical data:	
product brand name	SIRIUS
Product designation	Siren element
Type of voltage of the operating voltage	DC
Operating voltage	
• 1 at DC rated value	24 V
Relative positive tolerance of the operating voltage	10 %
Relative negative tolerance of the operating voltage	-10 %
Type of acoustic signal	Continuous tone / alternating tone
Loudness level	105 dB
Service life of acoustic signal device	5 000 h
Tone frequency	
• 1	2.5 kHz
• 2	3.5 kHz
Equipment marking	
• acc. to DIN EN 61346-2	P
• acc. to DIN EN 81346-2	P

#### Mechanical data:

Outer diameter of the signal column element 70 mm

#### Ambient conditions:

Ambient temperature during operation -20 ... +50 °C





Protection class IP IP40

Product function adjustable acoustic signal No

Height 79 mm

Width 70 mm

#### Certificates/approvals

General Product Approval	EMC	Declaration of Conformity	Shipping Approval	other	
 UL	 EAC	 C-Tick	 EG-Konf.	 DNV	<a href="#">Bestätigungen</a>

#### Further information

Information- and Downloadcenter (Catalogs, Brochures,...)

<http://www.siemens.com/industrial-controls/catalogs>

Industry Mall (Online ordering system)

<https://mall.industry.siemens.com/mall/en/en/Catalog/product?mlfb=8WD4420-0EA>

Cax online generator

<http://support.automation.siemens.com/WW/CAXorder/default.aspx?lang=en&mlfb=8WD4420-0EA>

Service&Support (Manuals, Certificates, Characteristics, FAQs,...)

<https://support.industry.siemens.com/cs/ww/en/ps/8WD4420-0EA>

Image database (product images, 2D dimension drawings, 3D models, device circuit diagrams, EPLAN macros, ...)

[http://www.automation.siemens.com/bilddb/cax\\_de.aspx?mlfb=8WD4420-0EA&lang=en](http://www.automation.siemens.com/bilddb/cax_de.aspx?mlfb=8WD4420-0EA&lang=en)

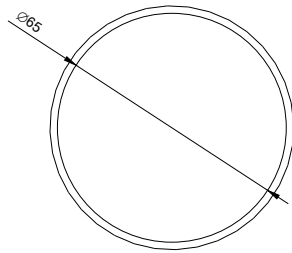
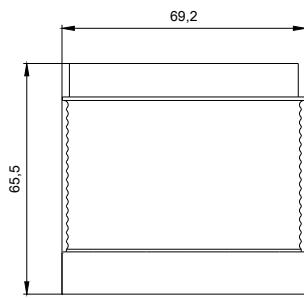

last modified:



WB 4441  
WB 8333 8WD44... ALL  
10/07/2016